



GROOVED COUPLINGS AND FITTINGS



WEIFANG YINUO CASTING CO.,LTD.

**GROOVED
COUPLINGS
AND
FITTINGS**



Company Profile

Weifang Yinuo Casting Co., Ltd is a large high-tech enterprise specialized in development, creation, casting, production and painting of ductile iron grooved fittings since 2001. The company locates in Weifang of Shandong Province, China, with convenient transportation closed to Jinan-Qingdao and Weifang-Laiyang motorway. With the fast development, the factory and supporting facilities now covers more than 3000m², the annual production capacity is well above 30,000 tons, and there are more than 200 employees, among which there are 10 engineering technicians and 5 senior engineers.

The company has strong technical strength, and possesses the world's first-class equipment and technology, as well as perfect testing methods. All rough castings of grooved fittings will be processed and produced by electric-furnace smelting, on-line monitoring and control and automatic molding methods. Now our facilities include eleven medium frequency furnace, four advanced Vertical parting molding lines and three painting lines. Every customer's requirements can be satisfied by customized services.

Yinuo's ductile iron grooved fittings have successively passed the China national type test, ISO9001 and FM&UL approvals etc. Our products are underwritten by China Ping An Insurance(Group) Co.,Ltd.. The grooved pipe fittings are widely used in fire fighting,





air-conditioning, water supply, sewage, cement, low-pressure steaming,, mine piping and ordinary piping delivery. YINUO is spreading all over the world and winning the appreciations from users at home and abroad.

Weifang YINUO pursues the core value as “Pragmatic honesty, quality first, continuous innovation and win-win cooperation” and insists on high quality products and competent service to win customers. We believe we would continuously develop new markets with YINUO brand and create a bright future together with our business friends.

- Corporate Vision: Where there is pipes, there is YINUO.
- Corporate Mission:
Connecting pipeline around the world, benefiting homes in every building.
- Competitive Strategy:
To supply market with perfect products, to win customers with excellent service.
- Core Value:
Pragmatic honesty, quality first, continuous innovation and win-win cooperation.
- Quality Value: We survive with quality and develop by technology.



Extensive Application

Yinuo' s grooved pipe fittings are widely used in fire fighting, air-conditioning, water supply, sewage, cement, low-pressure steaming,, mine piping and ordinary piping delivery etc.

Fire Fighting



Mining



Construction



Water Supply



Oil&gas Pipeline



Product show



Rigid Coupling



Rigid Coupling



Flexible Coupling



Rigid Coupling



90° Elbow



45° Elbow



22.5° Elbow



11.25° Elbow



Tee



Reducing Tee(grooved)



Reducing Tee(threaded)



Cross



Reducing Cross (grooved)



Reducing Cross (threaded)



Mechanical Tee (grooved)



Mechanical Tee (threaded)



Mechanical Cross (grooved)



Mechanical Cross (threaded)



U-BoltsMechanical Tee



Reducer (threaded)



Grooved Eccentric Reducer



Reducer (grooved)



Grooved Split Flange



Grooved Adaptor Flange



Cap

Surface finish: 1. Electrophoretic Paint 2. Epoxy 3. Painted 4. Galvanized
 Color: 1. Red 2. Orange 3. Blue 4. According to requirements

Rigid Coupling

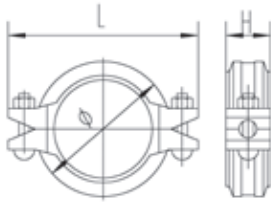

Nominal Size mm/in	Pipe O.D mm/in	Working Pressure PSI/MPa	Bolt Size No.—Size mm	Dimensions mm/in		
				Ø	L	H
25	33.7	300	2—M10*45	55.	95	45
1	1.327	2.07		2.165	3.74	1.772
32	42.4	300	2—M10*45	65	105	45
1¼	1.669	2.07		2.559	4.133	1.772
40	48.3	300	2—M10*45	71.	110	45
1½	1.900	2.07		2.795	4.331	1.772
50	60.3	300	2—M10*55	82	124	45
2	2.375	2.07		3.228	4.882	1.772
65	73.0	300	2—M10*55	98	141	45
2½	2.875	2.07		3.858	5.551	1.772
65	76.1	300	2—M10*55	100	142	45
3OD	3.000	2.07		3.937	5.59	1.772
80	88.9	300	2—M12*60	113	160	46
3	3.500	2.07		4.449	6.299	1.811
100	114.3	300	2—M12*65	142	190	49
4	4.500	2.07		5.59	7.48	1.929
125	139.7	300	2—M12*75	168	218	49
5,5OD	5.500	2.07		6.614	8.583	1.929
150	165.1	300	2—M12*75	194	244	49
6,5OD	6.500	2.07		7.638	9.606	1.929
150	168.3	300	2—M12*75	198	248	49
6	6.625	2.07		7.795	9.764	1.929
200	219.1	300	2—M16*100	256.	320	60
8	8.625	2.07		10.079	12.598	2.362
250	273	300	2—M22*130	328	420	64
10	10.748	2.07		12.913	16.535	2.52
300	323.9	300	2—M22*130	380	454	64
12	12.752	2.07		14.961	17.874	2.52

Flexible Coupling

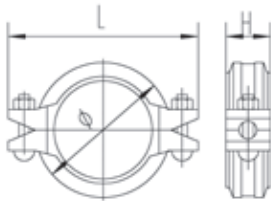

Nominal Size mm/in	Pipe O.D mm/in	Working Pressure PSI/MPa	Bolt Size No.—Size mm	Dimensions mm/in		
				Ø	L	H
25	33.7	300	2—M10*45	55.	95	45
1	1.327	2.07		2.165	3.74	1.772
32	42.4	300	2—M10*45	65	105	45
1¼	1.669	2.07		2.559	4.133	1.772
40	48.3	300	2—M10*45	71.	110	45
1½	1.900	2.07		2.795	4.331	1.772
50	60.3	300	2—M10*55	82	124	45
2	2.375	2.07		3.228	4.882	1.772
65	73.0	300	2—M10*55	98	141	45
2½	2.875	2.07		3.858	5.551	1.772
65	76.1	300	2—M10*55	100	142	45
3OD	3.000	2.07		3.937	5.59	1.772
80	88.9	300	2—M12*60	113	160	46
3	3.500	2.07		4.449	6.299	1.811
100	114.3	300	2—M12*65	142	190	49
4	4.500	2.07		5.59	7.48	1.929
125	139.7	300	2—M12*75	168	218	49
5,5OD	5.500	2.07		6.614	8.583	1.929
150	165.1	300	2—M12*75	194	244	49
6,5OD	6.500	2.07		7.638	9.606	1.929
150	168.3	300	2—M12*75	198	248	49
6	6.625	2.07		7.795	9.764	1.929
200	219.1	300	2—M16*100	256.	320	60
8	8.625	2.07		10.079	12.598	2.362
250	273	300	2—M22*130	328	420	64
10	10.748	2.07		12.913	16.535	2.52
300	323.9	300	2—M22*130	380	454	64
12	12.752	2.07		14.961	17.874	2.52

Specification and Dimensions

Reducing Coupling

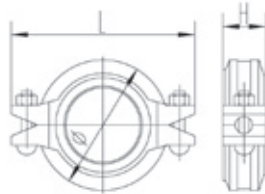

Nominal Size mm/in	Pipe O.D mm/in	Working Pressure PSI/MPa	Bolt Size No.—Size mm	Dimensions mm/in		
				Ø	L	H
50*32	60.3*42.4	300		86	125	47
2*1¼	2.375*1.669	2.07	2-M10*55	3.386	4.921	1.850
50*40	60.3*48.3	300		86	125	47
2*1½	2.375*1.900	2.07	2-M10*55	3.386	4.921	1.850
65*40	73.0*48.3	300		100	138	48
2½*1½	2.874*1.900	2.07	2-M10*55	3.937	5.433	1.890
65*50	73.0*60.3	300		100	138	48
2½*2	2.874*2.375	2.07	2-M10*55	3.937	5.433	1.890
65*40	76.1*48.3	300		102	140	48
3OD*1½	3*1.900	2.07	2-M10*55	4.016	5.512	1.890
65*50	76.1*60.3	300		102	140	48
3OD*2	3*2.375	2.07	2-M10*55	4.016	5.512	1.890
80*50	88.9*60.3	300		115	165	48
3*2	3.500*2.375	2.07	2-M12*65	4.527	6.496	1.890
80*65	88.9*73.0	300		115	165	48
3*2½	3.500*2.874	2.07	2-M12*65	4.527	6.496	1.890
80*65	88.9*76.1	300		115	165	48
3*3OD	3.500*3	2.07	2-M12*65	4.527	6.496	1.890
100*40	114.3*48.3	300		145	195	50
4*1½	4.500*1.902	2.07	2-M12*65	5.709	7.677	1.969
100*50	114.3*60.3	300		145	195	50
4*2	4.500*2.375	2.07	2-M12*65	5.709	7.677	1.969
100*65	114.3*73.0	300		145	195	50
4*2½	4.500*2.874	2.07	2-M12*65	5.709	7.677	1.969
100*65	114.3*76.1	300		145	195	50
4*3OD	4.500*3	2.07	2-M12*65	5.709	7.677	1.969
100*80	114.3*88.9	300		145	195	50
4*3	4.500*3.500	2.07	2-M12*65	5.709	7.677	1.969
125*50	139.7*60.3	300		170	220	50
5.5OD*2	5.500*2.375	2.07	2-M12*65	6.693	8.661	1.969
125*65	139.7*76.1	300		170	220	50
5.5OD*3OD	5.500*3	2.07	2-M12*65	6.693	8.661	1.969
125*80	139.7*88.9	300		170	220	50
5.5OD*3	5.500*3.500	2.07	2-M12*65	6.693	8.661	1.969
125*100	139.7*114.3	300		170	220	50
5.5OD*4	5.500*4.500	2.07	2-M12*65	6.693	8.661	1.969
150*65	165.1*76.1	300		195	245	50
6*3OD	6.500*3	2.07	2-M12*75	7.677	9.646	1.969
150*80	165.1*88.9	300		195	245	50
6.5OD*3	6.500*3.500	2.07	2-M12*75	7.677	9.646	1.969
150*100	165.1*114.3	300		195	245	50
6.5OD*4	6.500*4.500	2.07	2-M12*75	7.677	9.646	1.969
150*65	168.3*73.0	300		198	248	50
6*2½	6.625*2.874	2.07	2-M12*75	7.795	9.764	1.969
150*80	168.3*88.9	300		198	248	50
6*3	6.625*3.500	2.07	2-M12*75	7.795	9.764	1.969
150*100	168.3*114.3	300		198	248	50
6*4	6.625*4.500	2.07	2-M12*75	7.795	9.764	1.969
150*125	168.3*139.7	300		198	248	50
6*5.5OD	6.625*5.500	2.07	2-M12*75	7.795	9.764	1.969
200*65	219.1*76.1	300		258	320	60
8*3OD	8.625*3	2.07	2-M16*100	10.157	12.598	2.362
200*80	219.1*88.9	300		258	320	60
8*3	8.625*3.500	2.07	2-M16*100	10.157	12.598	2.362
200*100	219.1*114.3	300		258	320	60
8*4	8.625*4.500	2.07	2-M16*100	10.157	12.598	2.362
200*125	219.1*139.7	300		258	320	60
8*5.5OD	8.625*5.500	2.07	2-M16*100	10.157	12.598	2.362
200*150	219.1*165.1	300		258	320	60
8*6.5OD	8.625*6.500	2.07	2-M16*100	10.157	12.598	2.362
200*150	219.1*168.3	300		258	320	60
8*6	8.625*6.625	2.07	2-M16*100	10.157	12.598	2.362

U-bolted mechanical tee

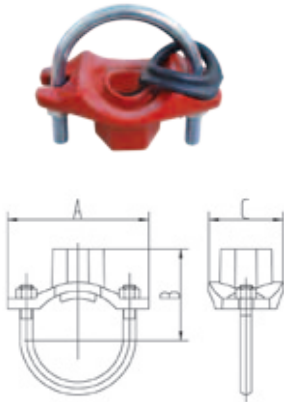

Nominal Size mm/in	Pipe O.D. mm/in	Working Pressure PSI/MPa	Bolt Size	Dimensions mm/in			Hole cutting dimensions mm/in
				No.-Size mm	A	B	
25*15 1*1/2	33.7*21.3 1.327*0.839	300 2.07	M10	85 3.346	50 1.969	50 1.969	24 0.945
25*20 1*3/4	33.7*26.9 1.327*1.059	300 2.07	M10	85 3.346	50 1.969	50 1.969	24 0.945
32*15 1 1/4*1/2	42.4*21.3 1.669*0.839	300 2.07	M10	91 3.583	41 1.614	58 2.283	30 1.181
32*20 1 1/4*3/4	42.4*26.9 1.669*1.059	300 2.07	M10	91 3.583	44 1.732	58 2.283	30 1.181
32*25 1 1/4*1	42.4*33.7 1.669*1.327	300 2.07	M10	91 3.583	50 1.969	58 2.283	30 1.181
40*15 1 1/2*1/2	48.3*21.3 1.900*0.839	300 2.07	M10	91 3.583	45 1.772	58 2.283	30 1.181
40*20 1 1/2*3/4	48.3*26.9 1.900*1.059	300 2.07	M10	91 3.583	51 2.008	58 2.283	30 1.181
40*25 1 1/2*1	48.3*33.7 1.900*1.327	300 2.07	M10	91 3.583	55 2.165	58 2.283	30 1.181
50*15 2*1/2	60.3*21.3 2.375*0.839	300 2.07	M10	95 3.740	53 2.087	58 2.283	30 1.181
50*20 2*3/4	60.3*26.9 2.375*1.059	300 2.07	M10	95 3.740	57 2.244	58 2.283	30 1.181
50*25 2*1	60.3*33.7 2.375*1.327	300 2.07	M10	95 3.740	60 2.362	58 2.283	30 1.181
65*15 2 1/2*1/2	73*21.3 2.874*0.839	300 2.07	M10	110 4.331	60 2.362	58 2.283	30 1.181
65*20 2 1/2*3/4	73*26.9 2.874*1.059	300 2.07	M10	110 4.331	63 2.480	58 2.283	30 1.181
65*25 2 1/2*1	73*33.7 2.874*1.327	300 2.07	M10	110 4.331	66 2.598	58 2.283	30 1.181
65*15 30D*1/2	76.1*21.3 3*0.839	300 2.07	M10	110 4.331	61 2.402	58 2.283	30 1.181
65*20 30D*3/4	76.1*26.9 3*1.059	300 2.07	M10	110 4.331	64 2.520	58 2.283	30 1.181
65*25 30D*1	76.1*33.7 3*1.327	300 2.07	M10	110 4.331	68 2.677	58 2.283	30 1.181

Specification and Dimensions

Mechanical Tee (grooved)

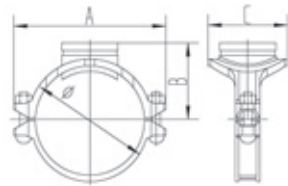

Nominal Size mm/in	Pipe O.D mm/in	Working Pressure PSI/MPa	Bolt Size No.-Size mm	Dimensions mm/in				Hole cutting dimensions mm/in
				Ø	A	B	C	
50*32 2*1¼	60.3*42.4 2.375*1.669	300 2.07	2-M10*55	78 3.071	115 4.527	68 2.677	74 2.913	46 1.8
50*40 2*1½	60.3*48.3 2.375*1.900	300 2.07		78 3.071	115 4.527	68 2.677	74 2.913	46 1.8
65*32 2½*1¼	73*42.4 2.87*1.669	300 2.07	2-M12*60	96 3.78	138 5.433	77 3.031	84 3.307	51 2
65*40 2½*1½	73*48.3 2.87*1.900	300 2.07		96 3.78	138 5.433	77 3.031	84 3.307	51 2
65*32 3OD*1¼	76.1*42.4 3*1.669	300 2.07	2-M12*60	99 3.898	140 5.512	78 3.071	84 3.307	51 2
65*40 3OD*1½	76.1*48.3 3*1.900	300 2.07		99 3.898	140 5.512	78 3.071	84 3.307	51 2
80*25 3*1	88.9*33.7 3.500*1.327	300 2.07	2-M12*65	112 4.409	150 5.906	85 3.346	79 3.110	38 1.5
80*32 3*1¼	88.9*42.4 3.500*1.669	300 2.07		112 4.409	150 5.906	85 3.346	84 3.307	51 2
80*40 3*1½	88.9*48.3 3.500*1.900	300 2.07	2-M12*65	112 4.409	150 5.906	85 3.346	84 3.307	51 2
80*50 3*2	88.9*60.3 3.500*2.375	300 2.07		112 4.409	150 5.906	85 3.346	100 3.937	64 2.500
100*25 4*1	114.3*33.7 4.500*1.327	300 2.07	2-M12*75	140 5.512	176 6.929	100 3.937	79 3.11	38 1.5
100*32 4*1¼	114.3*42.4 4.500*1.669	300 2.07		140 5.512	176 6.929	100 3.937	92 3.622	51 2
100*40 4*1½	114.3*48.3 4.500*1.900	300 2.07	2-M12*75	140 5.512	176 6.929	100 3.937	92 3.622	51 2
100*50 4*2	114.3*60.3 4.500*2.375	300 2.07		140 5.512	176 6.929	100 3.937	107 4.213	64 2.500
100*65 4*2½	114.3*73 4.500*2.874	300 2.07	2-M12*75	140 5.512	176 6.929	100 3.937	114 4.488	70 2.75
100*65 4*3OD	114.3*76.1 4.500*3	300 2.07		140 5.512	176 6.929	100 3.937	114 4.488	70 2.75
100*80 4*3	114.3*88.9 4.500*3.500	300 2.07	2-M12*75	140 5.512	176 6.929	100 3.937	134 5.276	89 3.5

Mechanical Tee (grooved)

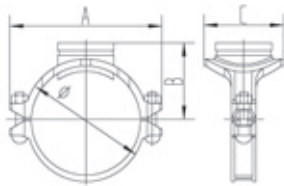

Nominal Size mm/in	Pipe O.D mm/in	Working Pressure PSI/MPa	Bolt Size No.-Size mm	Dimensions mm/in				Hole cutting dimensions mm/in
				Ø	A	B	C	
125*50 5.50D*2	139.7*60.3 5.500*2.375	300 2.07		166 6.535	215 8.465	113 4.448	107 4.213	64 2.500
125*65 5.50D*3OD	139.7*76.1 5.500*3	300 2.07		166 6.535	215 8.465	113 4.448	117 4.606	70 2.75
125*80 5.50D*3	139.7*88.9 5.500*3.500	300 2.07		166 6.535	215 8.465	113 4.448	134 5.276	89 3.5
150*50 6.50D*2	165.1*60.3 6.500*2.375	300 2.07		192 7.559	241 9.488	125 4.921	107 4.213	64 2.500
150*65 6.50D*3OD	165.1*76.1 6.500*3	300 2.07		192 7.559	241 9.488	125 4.921	117 4.606	70 2.75
150*80 6.50D*3	165.1*88.9 6.500*3.500	300 2.07		192 7.559	241 9.488	125 4.921	134 5.276	89 3.5
150*100 6.50D*4	165.1*114.3 6.500*4.500	300 2.07		192 7.559	241 9.488	130 5.118	160 6.299	114 4.5
150*32 6*1¼	168.3*42.4 6.625*1.669	300 2.07	2-M16*85	194 7.638	243 9.567	126 4.961	92 3.622	51 2
150*40 6*1½	168.3*48.3 6.625*1.900	300 2.07		194 7.638	243 9.567	126 4.961	92 3.622	51 2
150*50 6*2	168.3*60.3 6.625*2.375	300 2.07		194 7.638	243 9.567	126 4.961	107 4.213	64 2.500
150*65 6*2½	168.3*73 6.625*2.874	300 2.07		194 7.638	243 9.567	126 4.961	117 4.606	70 2.75
150*65 6*3OD	168.3*76.1 6.625*3	300 2.07		194 7.638	243 9.567	126 4.961	117 4.606	70 2.75
150*80 6*3	168.3*88.9 6.625*3.500	300 2.07		194 7.638	243 9.567	126 4.961	134 5.276	89 3.5
150*100 6*4	168.3*114.3 6.625*4.500	300 2.07		194 7.638	243 9.567	130 5.118	160 6.299	114 4.5
200*50 8*2	219.1*60.3 8.625*2.375	300 2.07		250 9.843	305 12.007	155 6.102	107 4.213	64 2.500
200*65 8*3OD	219.1*76.1 8.625*3	300 2.07		250 9.843	305 12.007	155 6.102	117 4.606	70 2.75
200*80 8*3	219.1*88.9 8.625*3.500	300 2.07	2-M16*100	250 9.843	305 12.007	155 6.102	134 5.276	89 3.5
200*100 8*4	219.1*114.3 8.625*4.500	300 2.07		250 9.843	310 12.205	160 6.299	160 6.299	114 4.5

Specification and Dimensions

Mechanical Tee (threaded)

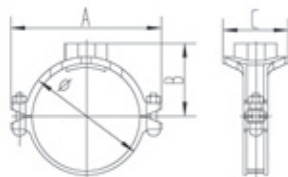

Nominal Size mm/in	Pipe O.D mm/in	Working Pressure PSI/MPa	Bolt Size No.-Size mm	Dimensions mm/in				Hole cutting dimensions mm/in
				Ø	A	B	C	
50*25 2*1	60.3*33.7 2.375*1.327	300 2.07		78 3.071	115 4.528	58 2.283	74 2.913	38 1.500
50*32 2*1¼	60.3*42.4 2.375*1.669	300 2.07	2-M10*55	78 3.071	115 4.528	58 2.283	74 2.913	46 1.8
50*40 2*1½	60.3*48.3 2.375*1.900	300 2.07		78 3.071	115 4.528	58 2.283	74 2.913	46 1.8
65*25 2½*1	73*33.7 2.87*1.327	300 2.07		97 3.819	138 5.433	68 2.677	77 3.031	38 1.5
65*32 2½*1¼	73*42.4 2.87*1.669	300 2.07		97 3.819	138 5.433	68 2.677	84 3.307	51 2
65*40 2½*1½	73*48.3 2.87*1.900	300 2.07	2-M12*60	97 3.819	138 5.433	68 2.677	84 3.307	51 2
65*25 30D*1	76.1*33.7 3*1.327	300 2.07		99 3.898	140 5.512	70 2.756	77 3.031	38 1.5
65*32 30D*1¼	76.1*42.4 3*1.669	300 2.07		99 3.898	140 5.512	70 2.756	84 3.307	51 2
65*40 30D*1½	76.1*48.3 3*1.900	300 2.07		99 3.898	140 5.512	70 2.756	84 3.307	51 2
80*25 3*1	88.9*33.7 3.500*1.327	300 2.07		112 4.409	150 5.906	76 2.992	79 3.110	38 1.5
80*32 3*1¼	88.9*42.4 3.500*1.669	300 2.07	2-M12*65	112 4.409	150 5.906	76 2.992	84 3.307	51 2
80*40 3*1½	88.9*48.3 3.500*1.900	300 2.07		112 4.409	150 5.906	76 2.992	84 3.307	51 2
80*50 3*2	88.9*60.3 3.500*2.375	300 2.07		112 4.409	150 5.906	76 2.992	100 3.937	64 2.500
100*25 4*1	114.3*33.7 4.500*1.327	300 2.07		140 5.512	176 6.929	90 3.543	79 3.11	38 1.5
100*32 4*1¼	114.3*42.4 4.500*1.669	300 2.07		140 5.512	176 6.929	90 3.543	92 3.622	51 2
100*40 4*1½	114.3*48.3 4.500*1.900	300 2.07		140 5.512	176 6.929	90 3.543	92 3.622	51 2
100*50 4*2	114.3*60.3 4.500*2.375	300 2.07	2-M12*75	140 5.512	176 6.929	90 3.543	107 4.213	64 2.500
100*65 4*2½	114.3*73 4.500*2.874	300 2.07		140 5.512	176 6.929	97 3.819	114 4.488	70 2.75
100*65 4*30D	114.3*76.1 4.500*3	300 2.07		140 5.512	176 6.929	97 3.819	114 4.488	70 2.75
100*80 4*3	114.3*88.9 4.500*3.500	300 2.07		140 5.512	176 6.929	95 3.74	134 5.276	89 3.5

Mechanical Tee (threaded)

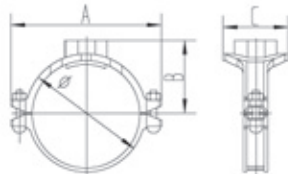

Nominal Size mm/in	Pipe O.D mm/in	Working Pressure PSI/MPa	Bolt Size No.-Size mm	Dimensions mm/in				Hole cutting dimensions mm/in
				Ø	A	B	C	
125*25 5.50D*1	139.7*33.7 5.500*1.327	300 2.07		166 6.535	215 8.465	103 4.055	79 3.11	38 1.5
125*32 5.50D*1¼	139.7*42.4 5.500*1.669	300 2.07		166 6.535	215 8.465	103 4.055	92 3.622	51 2
125*40 5.50D*1½	139.7*48.3 5.500*1.900	300 2.07		166 6.535	215 8.465	103 4.055	92 3.622	51 2
125*50 5.50D*2	139.7*60.3 5.500*2.375	300 2.07		166 6.535	215 8.465	108 4.252	107 4.213	64 2.500
125*65 5.50D*3OD	139.7*76.1 5.500*3	300 2.07		166 6.535	215 8.465	108 4.252	114 4.488	70 2.75
125*80 5.50D*3	139.7*88.9 5.500*3.500	300 2.07		166 6.535	215 8.465	108 4.252	132 5.197	89 3.5
150*25 6.50D*1	165.1*33.7 6.500*1.327	300 2.07		192 7.559	241 9.488	116 4.567	79 3.11	38 1.5
150*32 6.50D*1¼	165.1*42.4 6.500*1.669	300 2.07		192 7.559	241 9.488	116 4.567	92 3.622	51 2
150*40 6.50D*1½	165.1*48.3 6.500*1.900	300 2.07		192 7.559	241 9.488	116 4.567	92 3.622	51 2
150*50 6.50D*2	165.1*60.3 6.500*2.375	300 2.07	2-M16*85	192 7.559	241 9.488	121 4.764	107 4.213	64 2.500
150*65 6.50D*3OD	165.1*76.1 6.500*3	300 2.07		192 7.559	241 9.488	126 4.961	114 4.488	70 2.75
150*80 6.50D*3	165.1*88.9 6.500*3.500	300 2.07		192 7.559	241 9.488	126 4.961	132 5.197	89 3.5
150*25 6*1	168.3*33.7 6.625*1.327	300 2.07		194 7.638	243 9.567	117 4.606	79 3.11	38 1.5
150*32 6*1¼	168.3*42.4 6.625*1.669	300 2.07		194 7.638	243 9.567	117 4.606	92 3.622	51 2
150*40 6*1½	168.3*48.3 6.625*1.900	300 2.07		194 7.638	243 9.567	117 4.606	92 3.622	51 2
150*50 6*2	168.3*60.3 6.625*2.375	300 2.07		194 7.638	243 9.567	122 4.803	107 4.213	64 2.500
150*65 6*2½	168.3*73 6.625*2.874	300 2.07		194 7.638	243 9.567	127 5	117 4.606	70 2.75
150*80 6*3	168.3*88.9 6.625*3.500	300 2.07		194 7.638	243 9.567	127 5	134 5.276	89 3.5
200*25 8*1	219.1*33.7 8.625*1.327	300 2.07		250 9.843	305 12.007	145 5.709	79 3.11	38 1.5
200*32 8*1¼	219.1*42.4 8.625*1.669	300 2.07		250 9.843	305 12.007	145 5.709	92 3.622	51 2
200*40 8*1½	219.1*48.3 8.625*1.900	300 2.07		250 9.843	310 12.205	145 5.709	92 3.622	51 2
200*50 8*2	219.1*60.3 8.625*2.375	300 2.07	2-M16*100	250 9.843	305 12.007	150 5.906	107 4.213	64 2.500
200*65 8*3OD	219.1*76.1 8.625*3	300 2.07		250 9.843	305 12.007	155 6.102	117 4.606	70 2.75
200*80 8*3	219.1*88.9 8.625*3.500	300 2.07		250 9.843	305 12.007	155 6.102	134 5.276	89 3.5
200*100 8*4	219.1*114.3 8.625*4.500	300 2.07		250 9.843	305 12.007	155 6.102	160 6.299	114 4.5

Specification and Dimensions

Grooved Split Flange 1.6Mpa

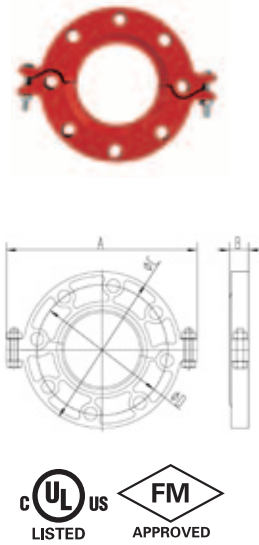

Nominal Size mm/in	Pipe O.D mm/in	Working Pressure PSI/MPa	Dimensions mm/in				Bolt Size No.-Size mm
			A mm/in	B mm/in	C mm/in	D mm/in	
50	60.3	230	222	23	165	125	4-M16
2	2.375	1.6	8.740	0.906	6.496	4.921	
65	73	230	234	23	185	145	4-M16
2½	2.874	1.6	9.212	0.906	7.283	5.708	
65	76.1	230	234	23	185	145	4-M16
3OD	3.000	1.6	9.212	0.906	7.283	5.708	
80	88.9	230	252	23	200	160	8-M16
3	3.500	1.6	9.921	0.906	7.874	6.299	
100	114.3	230	278	24	220	180	8-M16
4	4.500	1.6	10.945	0.944	8.661	7.086	
125	139.7	230	318	24	250	210	8-M16
5.5OD	5.500	1.6	12.5	0.944	9.842	8.267	
150	165.1	230	346	24.5	285	240	8-M20
6.5OD	6.5	1.6	13.622	0.965	11.22	9.448	
150	168.3	230	346	24.5	285	240	8-M20
6	6.625	1.6	13.622	0.965	11.22	9.448	
200	219.1	230	414	30	340	295	12-M20
8	8.625	1.6	16.299	1.181	13.38	11.614	

Grooved Split Flange ANSI- Class150

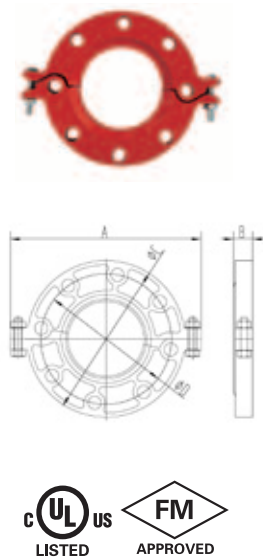

Nominal Size mm/in	Pipe O.D mm/in	Working Pressure PSI/MPa	Dimensions mm/in				Bolt Size No.-Size mm
			A mm/in	B mm/in	C mm/in	D mm/in	
50	60.3	300	206	22	152	120.7	4-5/8
2	2.375	2.07	8.110	0.866	5.984	4.75	
65	73.0	300	230	22	178	139.7	4-5/8
2½	2.875	2.07	9.055	0.866	7.007	5.5	
80	88.9	300	242	24	191	152.4	4-5/8
3	3.500	2.07	9.527	0.944	7.519	6	
100	114.3	300	280	24	229	190.5	8-5/8
4	4.500	2.07	11.023	0.944	9.015	7.5	
125	141.3	300	325	24.5	254	216	8-3/4
5	5.562	2.07	12.795	0.964	10	8.5	
150	168.3	300	346	24.5	280	241.3	8-3/4
6	6.626	2.07	13.622	0.964	11.023	9.5	
200	219.1	300	415	30	341.4	298.5	8-3/4
8	8.625	2.07	16.338	1.181	13.44	11.75	

**Grooved
Adaptor
Flange
1.6Mpa**

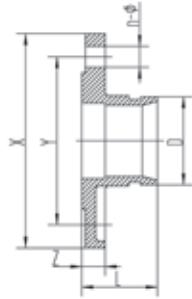

Nominal Size mm/in	Pipe O.D mm/in D	Working Pressure PSI/MPa	Dimensions mm/in				Bolt Size No.-Size mm
			L mm/in	X mm/in	Y mm/in	Z mm/in	
50 2	60.3 2.375	230 1.6	60.3 2.37	165 6.496	125 4.92	16 0.629	4-M16
65 2½	73.0 2.875	230 1.6	60.3 2.37	185 7.283	145 5.70	16 0.629	4-M16
65 30D	76.1 3.000	230 1.6	60.3 2.37	185 7.283	145 5.70	16 0.629	4-M16
80 3	88.9 3.500	230 1.6	60.3 2.37	200 7.874	160 6.29	16 0.629	8-M16
100 4	114.3 4.500	230 1.6	70 2.755	220 8.661	180 7.08	16 0.629	8-M16
125 5.5OD	139.7 5.500	230 1.6	70 2.755	250 9.842	210 8.26	18 0.708	8-M16
150 6.5OD	165.1 6.500	230 1.6	70 2.755	285 11.22	240 9.448	18 0.708	8-M20
150 6	168.3 6.625	230 1.6	70 2.755	285 11.22	240 9.448	18 0.708	8-M20
200 8	219.1 8.625	230 1.6	76.1 2.99	340 13.38	295 11.61	19 0.748	12-M20

**Grooved
Adaptor
Flange**

**ANSI-
Class150**

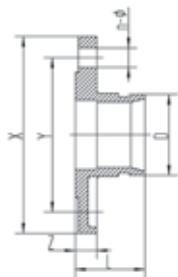

Nominal Size mm/in	Pipe O.D mm/in D	Working Pressure PSI/MPa	Dimensions mm/in				Bolt Size No.-Size mm
			L mm/in	X mm/in	Y mm/in	Z mm/in	
50 2	60.3 2.375	300 2.07	65 2.559	152 5.98	120.7 4.75	16 0.63	4-5/8
65 2½	73.0 2.875	300 2.07	65 2.559	178 7.00	139.7 5.5	16 0.63	4-5/8
80 3	88.9 3.500	300 2.07	65 2.559	190 7.48	152.5 6	16 0.63	4-5/8
100 4	114.3 4.500	300 2.07	70 2.755	229 9.015	190.5 7.5	16 0.63	8-5/8
125 5	141.3 5.562	300 2.07	70 2.755	254 10	216 8.5	18 0.71	8-3/4
150 6	168.3 6.625	300 2.07	70 2.755	279 10.98	241.3 9.5	18 0.71	8-3/4
200 8	219.1 8.625	300 2.07	80 3.15	343 13.50	298.5 11.75	19 0.75	8-3/4

Specification and Dimensions

Tee



Cross

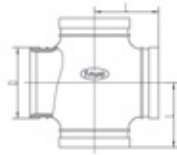

Reducer



Cap



Size	Pipe O.D. mm/in	Tee		Cross		Reducer grooved	Reducer threaded	Cap
		Standard	Short	Standard	Short			
		L	L	L	L	L	L	L
DN in	mm in	mm in	mm in	mm in	mm in	mm in	mm in	mm in
25	33.7	57	57	57	57	64	64	22
1	1.327	2.244	2.244	2.244	2.244	2.52	2.52	0.866
32	42.4	70	60	70	60	64	64	22
1¼	1.669	2.75	2.36	2.75	2.36	2.52	2.52	0.866
40	48.3	70	60	70	60	64	64	22
1½	1.900	2.75	2.36	2.75	2.36	2.52	2.52	0.866
50	60.3	83	70	83	70	64	64	22
2	2.375	3.267	2.75	3.267	2.75	2.52	2.52	0.866
65	73.0	95	76	95	76	64	64	22
2½	2.875	3.74	2.99	3.74	2.99	2.52	2.52	0.866
65	76.1	95	76	95	76	64	64	22
3OD	3.000	3.74	2.99	3.74	2.99	2.52	2.52	0.866
80	88.9	108	86	108	86	64	64	22
3	3.500	4.25	3.385	4.25	3.385	2.52	2.52	0.866
100	114.3	127	102	127	102	76	76	25
4	4.500	5	4.016	5	4.016	2.99	2.99	0.99
125	139.7	140	122	140	122	89	89	25
5.5OD	5.500	5.5	4.803	5.5	4.803	3.504	3.504	0.99
150	165.1	165	140	165	140	102	102	25
6.5OD	6.500	6.5	5.511	6.5	5.511	4.016	4.016	0.99
150	168.3	165	140	165	140	102	102	25
6	6.625	6.5	5.511	6.5	5.511	4.016	4.016	0.99
200	219.1	197	175	197	175	127	127	30
8	8.625	7.75	6.89	7.75	6.89	5	5	1.181
250	273.0	229	215	229	215	152	152	32
10	10.750	9	8.464	9	8.464	5.984	5.984	1.259
300	323.9	254	245	254	245	178	178	32
12	12.750	10	9.646	10	9.646	7	7	1.259



90° Elbow

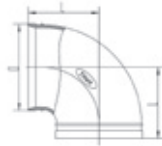

45° Elbow



22.5° Elbow



11.25° Elbow

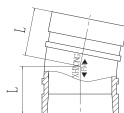

Size	Pipe O.D. mm/in	90° Elbow		45° Elbow	22.5° Elbow	11.25° Elbow
		Standard	Short			
		L	L	L	L	L
DN in	mm in	mm in	mm in	mm in	mm in	mm in
25 1	33.7 1.327	57 2.244	57 2.244	38 1.496	41 1.61	35 1.378
32 1¼	42.4 1.669	70 2.75	60 2.36	45 1.772	45 1.772	35 1.378
40 1½	48.3 1.900	70 2.75	60 2.36	45 1.772	45 1.772	35 1.378
50 2	60.3 2.375	83 3.267	70 2.75	51 2.	51 2.	35 1.378
65 2½	73.0 2.875	95 3.74	76 2.99	57 2.244	51 2.	38 1.496
65 3OD	76.1 3.000	95 3.74	76 2.99	57 2.244	51 2.	38 1.496
80 3	88.9 3.500	108 4.25	86 3.385	64 2.52	57 2.244	38 1.496
100 4	114.3 4.500	127 5	102 4.016	76 2.992	73 2.874	48 1.89
125 5.5OD	139.7 5.500	140 5.5	122 4.803	83 3.268	73 2.874	51 2
150 6.5OD	165.1 6.500	165 6.5	140 5.511	89 3.504	79 3.11	51 2
150 6	168.3 6.625	165 6.5	140 5.511	89 3.504	79 3.11	51 2
200 8	219.1 8.625	197 7.75	175 6.89	108 4.252	98 3.858	51 2
250 10	273.0 10.750	229 9	215 8.464	121 4.764	111 4.37	54 2.126
300 12	323.9 12.750	254 10	245 9.646	133 5.236	124 4.88	57 2.244

Specification and Dimensions

Roll Groove Dimensions

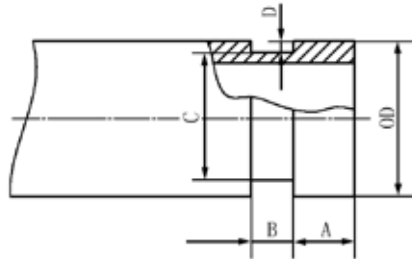

Nominal Size mm/in	Pipe OD			Gasket seat A ± 0.76/ ± 0.03 mm/in	Groove Width B ± 0.76/ ± 0.03 mm/in	Groove Dia C		Groove Depth D(ref) mm/in	Max Allow Flare Dia F mm/in	Min. Allow wall thickness T mm/in
	Basic mm/in	Tolerance mm/in				Basic mm/in	Tolerance mm/in			
25	33.7	+0.41	-0.68	15.88	7.14	30.23	-0.38	1.60	34.5	1.8
1	1.327	+0.016	-0.026	0.625	0.281	1.190	-0.015	0.063	1.358	0.071
32	42.4	+0.50	-0.6	15.88	7.14	38.99	-0.38	1.60	43.3	1.8
1 1/4	1.669	+0.020	-0.023	0.625	0.281	1.535	-0.015	0.063	1.705	0.071
40	48.3	+0.44	-0.52	15.88	7.14	45.09	-0.38	1.60	49.4	1.8
1 1/2	1.900	+0.017	-0.020	0.625	0.281	1.779	-0.015	0.063	1.945	0.071
50	60.3	+0.61	-0.61	15.88	8.74	57.15	-0.38	1.60	62.2	1.8
2	2.375	+0.024	-0.024	0.625	0.344	2.250	-0.015	0.063	2.449	0.071
65	73.0	+0.74	-0.74	15.88	8.74	69.09	-0.46	1.98	75.2	2.3
2 1/2	2.875	+0.029	-0.029	0.625	0.344	2.720	-0.018	0.078	2.961	0.091
65	76.1	+0.76	-0.76	15.88	8.74	72.26	-0.46	1.99	77.7	2.3
3OD	3.000	+0.030	-0.030	0.625	0.344	2.845	-0.018	0.078	3.059	0.091
80	88.9	+0.89	-0.79	15.88	8.74	84.94	-0.46	1.98	90.6	2.3
3	3.500	+0.035	-0.031	0.625	0.344	3.344	-0.018	0.078	3.567	0.091
100	108.0	+1.07	-0.79	15.88	8.74	103.73	-0.51	2.11	109.7	2.3
4.25OD	4.250	+0.042	-0.031	0.625	0.344	4.084	-0.020	0.083	4.319	0.091
100	114.3	+1.14	-0.79	15.88	8.74	110.08	-0.51	2.11	116.2	2.3
4	4.500	+0.045	-0.031	0.625	0.344	4.334	-0.020	0.083	4.575	0.091
125	133.0	+1.32	-0.79	15.88	8.74	129.13	-0.51	2.11	134.9	2.9
5.25OD	5.250	+0.052	-0.031	0.625	0.344	5.084	-0.020	0.083	5.311	0.114
125	139.7	+1.40	-0.79	15.88	8.74	135.48	-0.51	2.11	141.7	2.9
5.5OD	5.500	+0.055	-0.031	0.625	0.344	5.334	-0.020	0.083	5.579	0.114
125	141.3	+1.42	-0.79	15.88	8.74	137.03	-0.56	2.13	143.5	2.9
5	5.563	+0.056	-0.031	0.625	0.344	5.395	-0.022	0.084	5.650	0.114
150	159.0	+1.60	-0.79	15.88	8.74	154.50	-0.56	2.16	161.0	2.9
6.25OD	6.250	+0.063	-0.031	0.625	0.344	6.083	-0.022	0.085	6.339	0.114
150	165.1	+1.60	-0.79	15.88	8.74	160.8	-0.56	2.16	167.1	2.9
6.5OD	6.500	+0.063	-0.031	0.625	0.344	6.330	-0.022	0.085	6.579	0.114
150	168.3	+1.60	-0.79	15.88	8.74	163.96	-0.56	2.16	170.7	2.9
6	6.625	+0.063	-0.031	0.625	0.344	6.455	-0.022	0.085	6.720	0.114
200A	216.3	+1.60	-0.79	19.05	11.91	211.60	-0.64	2.35	219.8	2.9
8	8.516	+0.063	-0.031	0.750	0.469	8.331	-0.025	0.093	8.653	0.114
200	219.1	+1.60	-0.79	19.05	11.91	214.40	-0.64	2.34	221.5	2.9
8	8.625	+0.063	-0.031	0.750	0.469	8.441	-0.025	0.092	8.720	0.114
250A	267.4	+1.60	-0.79	19.05	11.91	262.60	-0.69	2.40	270.9	3.6
10	10.528	+0.063	-0.031	0.750	0.469	10.339	-0.027	0.095	10.665	0.142
250	273.0	+1.60	-0.79	19.05	11.91	268.28	-0.69	2.39	275.4	3.6
10	10.750	+0.063	-0.031	0.750	0.469	10.562	-0.027	0.094	10.842	0.142
300A	318.5	+1.60	-0.79	19.05	11.91	312.90	-0.76	2.77	322.0	4.0
12	12.539	+0.063	-0.031	0.750	0.469	12.319	-0.030	0.109	12.677	0.158
300	323.9	+1.60	-0.79	19.05	11.91	318.29	-0.76	2.77	326.2	4.0
12	12.750	+0.063	-0.031	0.750	0.469	12.531	-0.030	0.109	12.842	0.158
350	377.0	+1.60	-0.79	23.83	11.91	371.44	-0.76	2.77	379.5	4.5
14	14.842	+0.063	-0.031	0.938	0.469	14.623	-0.030	0.109	14.941	0.177
400	426.0	+1.60	-0.79	23.83	11.91	420.46	-0.76	2.77	428.5	4.5
16	16.772	+0.063	-0.031	0.938	0.469	16.553	-0.030	0.109	16.870	0.177
500	529.0	+1.60	-0.79	25.40	11.91	523.46	-0.76	2.77	533.0	5.0
20	20.827	+0.063	-0.031	1.000	0.469	20.608	-0.030	0.109	20.984	0.197

Gasket



Gasket	Material	Temperature Range	Recommendations	Color
E	EPDM	-34°C~ +110°C (-30~ +230°C)	Recommended for hot water, dilute acid, oil-free gas and other chemicals(except for hydrocarbon) within the specified temperature range. Not recommended for petroleum and hydrocarbon.	Green Strip
D	NBR	-29°C~ +82°C (-20~ +180°C)	Recommended for petroleum products, gas with oil vapors, mineral oil and vegetable oil. Not recommended for high temperature materials.	Orange Strip
S	Silicon Rubber	-40°C~ +177°C (-40~ +350°C)	Recommended for high temperature and dry air, and some high temperature chemicals.	White

Note: Different fluid requires different kinds of rubber gasket. We can offer products in accordance with customer’ s demands.

Installation Instructions

Installation Instruction for Rigid & Flexible Coupling



1. Pipe preparation

Check pipe end for proper groove dimensions and assure that pipe end is free of indentations and projections that would prevent proper sealing.



2. Lubricate gasket

Check gasket to be sure it's compatible for the intended service. Apply thin lubricant to the outside and seal lips of the gasket.



3. Gasket installation

Slip the gasket over one pipe, making sure the gasket lip does not overhang the pipe end.



4. Alignment

After aligning two pipe ends together, pull the gasket into position, centering between the grooves on each pipe. The gasket should not extend into the groove on either pipe.



5. Housing installation

Remove one bolt & nut and loosen the other nut. Place one housing over the gasket, making sure the housing fits into the pipe grooves. Swing the other housing over the gasket and into the grooves on both pipes. Reinsert the bolt and connect two housings.



6. Tighten nuts

Firstly tighten nuts by hand and make sure oval neck bolt completely fits into bolt hole. Then securely tighten nuts alternatively and equally to specified bolt torque by using spanner.



7. Installation complete - rigid coupling

For rigid coupling, keep the gaps between bolt pads evenly spaced. Gaskets cannot be visual.



8. Installation complete - flexible coupling

For flexible coupling, two housing should be connected iron to iron. Gaskets cannot be visual.

Caution

Proper torquing of bolts is required to obtain specified performance.
 -Over torquing the bolts may result in damage to the bolt and /or casting which could result in pipe joint separation.
 -Under torquing the bolts may result in lower pressure retention capabilities, lower bend load capabilities, joint leakage and pipe joint separation. Pipe joint separation may result in significant property damage and serious injury.

Specified Bolt Torque

ANSI BOLTS		
Bolt Size	Specified Bolt Torque	
	Lbs-Ft.	N.m
3/8	30-45	40-60
1/2	80-100	110-135
5/8	100-130	135-175
3/4	130-180	175-245
7/8	180-240	245-325

Installation Instruction for Threaded & Grooved Mechanical Tee



1. Pipe preparation

Clean the gasket sealing surface within 16mm of the hole and inspect the sealing surface visually for defects that may prevent proper sealing of the gasket. Don't drill the hole on weld line.



2. Remove burrs

Remove any burrs or slug before installation to protect the gasket and prevent leakage.



3. Gasket & Housing Installation

Insert the gasket into outlet housing and make sure the tab in the gasket line up with the tab recessing in the housing. Align outlet housing over the pipe hole making sure that the locating collar is in the pipe hole.



4. Alignment

Align the strap around the pipe, insert the bolts and tighten the nuts.



5. Tighten nuts

Alternatively and evenly tighten the nuts to the specified bolt torque.



6. Installation complete

There should be even gaps on two sides between the upper and lower housings.

Caution

Proper torquing of bolts is required to obtain specified performance.
 –Over torquing the bolts may result in damage to the bolt and /or casting which could result in pipe joint separation.
 –Under torquing the bolts may result in lower pressure retention capabilities, lower bend load capabilities, joint leakage and pipe joint separation. Pipe joint separation may result in significant property damage and serious injury.

Specified Bolt Torque

ANSI BOLTS		
Bolt Size	Specified Bolt Torque	
	Lbs-Ft.	N.m
3/8	30-45	40-60
1/2	80-100	110-135
5/8	100-130	135-175
3/4	-	-
7/8	-	-

INSTALLATION INSTRUCTIONS

Installation Instruction for U-Bolt Mechanical Tee



1. Pipe preparation

Clean the gasket sealing surface within 16mm of the hole and inspect the sealing surface visually for defects that may prevent proper sealing of the gasket. Don't drill the hole on weld line.



2. Remove burrs

Remove any burrs or slug before installation to protect the gasket and prevent leakage.



3. Gasket installation

Insert the gasket into outlet housing properly. Align outlet housing over the pipe hole making sure that the locating collar is in the pipe hole.



4. Alignment

Attach the U-bolt from the other side and tighten the nuts.



5. Tighten nuts

Alternatively and evenly tighten the nuts to the specified bolt torque.



6. Installation complete

Caution

Proper torquing of bolts is required to obtain specified performance.
 -Over torquing the bolts may result in damage to the bolt and /or casting which could result in pipe joint separation.
 -Under torquing the bolts may result in lower pressure retention capabilities, lower bend load capabilities, joint leakage and pipe joint separation. Pipe joint separation may result in significant property damage and serious injury.

Specified Bolt Torque

ANSI BOLTS		
Bolt Size	Specified Bolt Torque	
Inch	Lbs-Ft.	N.m
3/8	30-45	40-60
1/2	80-100	110-135
5/8	100-130	135-175
3/4	-	-
7/8	-	-

Installation Instruction for Grooved Flange



1. Pipe preparation

Check pipe end for proper groove dimensions and assure that pipe end is free of indentations and projections that would prevent proper sealing.



2. Lubricate gasket

Check gasket to be sure it's compatible for the intended service. Apply thin lubricant to the outside and seal lips of the gasket.

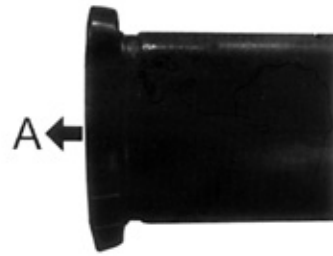

3. Gasket installation

Slip the gasket over one pipe with the gasket opening side towards "A". Make sure the gasket lip is even with the pipe end.



4. Housing installation

Remove one bolts and nuts and loosen the other nut. Place two housings over the gasket, making sure the housing fit into the pipe grooves. Reinsert the bolt and connect two housings.



5. Tighten nuts

Securely tighten nuts alternatively and equally to specified bolt torque by using spanner.

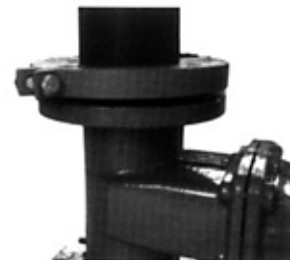

6. Connect mating flange

Align flange bolt holes by mating flange(or valve) bolt holes. Insert a standard flange bolt through bolt hole and tighten a nut by hand. Insert another bolt opposite the first and tighten a nut by hand. Continue this until all bolt holes are fitted. Tighten nuts evenly to specified bolt torque and keep flange faces remain parallel. Installation complete.

Caution

Proper torquing of bolts is required to obtain specified performance.
 –Over torquing the bolts may result in damage to the bolt and /or casting which could result in pipe joint separation.
 –Under torquing the bolts may result in lower pressure retention capabilities, lower bend load capabilities, joint leakage and pipe joint separation. Pipe joint separation may result in significant property damage and serious injury.

Specified Bolt Torque

ANSI BOLTS		
Bolt Size	Specified Bolt Torque	
	Lbs-Ft.	N.m
M10		
M12	30-45	40-60
M16	80-100	110-135
M20	-	-
M22	-	-
M24	-	-



GROOVED COUPLINGS
AND FITTINGS

WEIFANG YINUO CASTING CO.,LTD.

Address: Jiulong Industrial Park, Jiulong Street Office, Fangzi District. Weifang, Shandong Province, China 261203

Tel: (86) 536 8868757

Fax: (86) 536 8868757

E-mail: kiccy-sales@yinuocasting.com
yinuo-sales@yinuocasting.com

Http: [//www.yinuocasting.com](http://www.yinuocasting.com)

If you need more information, please contact us.